

NOTE: Recommended for low voltage <32VDC (automotive) applications.
Also suited for use in 125-250VAC applications, restrictions may apply (see below).

| Rating [mA] | Ud (Voltage drop) [mV] | iMaXX Reference |
|------------------|-----------------------------|-----------------|
| 100 | 2500 | FT4100 |
| 125 | 2000 | FT4125 |
| 160 | 1900 | FT4160 |
| 200 | 1500 | FT4200 |
| 315 | 1100 | FT4315 |
| 400 | 1000 | FT4400 |
| 500 | 900 | FT4500 |
| 630 | 300 | FT4630 |
| 800 | 250 | FT4800 |
| | | |
| | | |
| | | |

| Rating [A] | Ud (Voltage drop) [mV] | iMaXX Reference |
|-----------------|-----------------------------|-----------------|
| 1 | 150 | FT4001 |
| 1.25 | 150 | FT4001.25 |
| 1.6 | 150 | FT4001.6 |
| 2 | 150 | FT4002 |
| 2.5 | 120 | FT4002.5 |
| 3.15 | 100 | FT4003 |
| 4 | 100 | FT4004 |
| 5 | 100 | FT4005 |
| 6.3 | 100 | FT4006 |
| 8 | ns * | FT4008 |
| 10 | ns * | FT4010 |

*) ns means not in standard, not specified

| Fusing time, ratings 32 - 100mA | | |
|---------------------------------|---------|---------|
| Load [%] | Minimum | Maximum |
| 210 % | - | 120 s |
| 275 % | 200 ms | 10 s |
| 400 % | 40 ms | 3 s |
| 1000 % | 10 ms | 300 ms |

| Fusing time, ratings 125mA - 6.3A | | |
|-----------------------------------|---------|---------|
| Load [%] | Minimum | Maximum |
| 210 % | - | 120 s |
| 275 % | 600 ms | 10 s |
| 400 % | 150 ms | 3 s |
| 1000 % | 20 ms | 300 ms |

| Fusing time, ratings 8A - 15A | | |
|-------------------------------|---------|---------|
| Load [%] | Minimum | Maximum |
| 210 % | - | 1800 s |
| 275 % | 600 ms | 10 s |
| 400 % | 150 ms | 3 s |
| 1000 % | 20 ms | 300 ms |

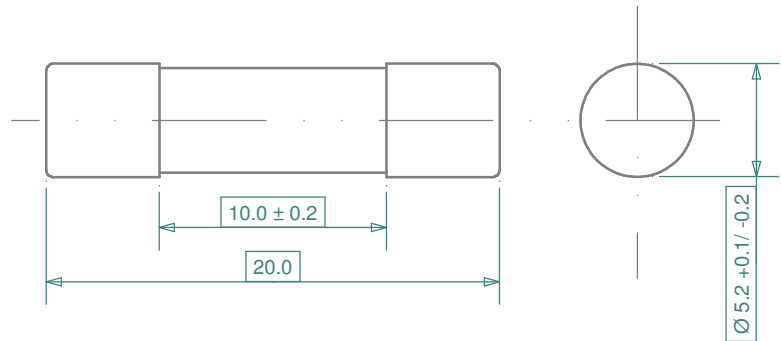

| NOTES |
|--|
| Glass tube with nickel plated caps |
| IEC 127, BS4265 and CEE4 standard sheet III |
| Marked with voltage and current rating |
| Range from 500mA up to 6.3A per standards |
| Ratings not in IEC standard, from 8 - 10A also available |
| Breaking capacity 35A or 10 x rated current (In), whichever is greater |
| Cycling test as per IEC 127 and BS4265 |
| Operating ambient temperature from 15°C to 35°C per standards |
| |
| |
| |

| Revisions | | | Drawn | Date | Appr. |
|-----------|-------|-------------------------------|-----------|-------|-------|
| a | 07/07 | re-drawn | Checked | 09/04 | GRH |
| b | 12/09 | extended specification detail | Standards | 06/13 | BE |
| c | 06/13 | added note on voltage rating | Approved | 06/13 | AdH |



| | | | | | |
|--|--|-------------|---|----------------|---------------------------------------|
| | | Scale 3 : 1 | | Title | FT4000, glassOTO 5x20mm time-lag fuse |
| | | Projection | Tolerance ± 0.5 mm unless otherwise noted | Drawing type | schematic |
| | | | | Drawing number | FT4000 drawing 1 |
| | | | | Sheet | 1 of 1 |
| | | | | Layers | 0 1 2 6 8 9 |